

USER GUIDE



IT-2200 InterTrack BELT LUXURY TREADMILL

SAFETY & WARNING

Install the treadmill in a dry location away from water, dampness, and dust.

Do not run on the treadmill with bare feet. Wear appropriate exercise clothing.

Plug the treadmill into a grounded electrical socket.

Do not plug into an extension board.

Keep children away from the treadmill.

Before operating, ensure safety clip is attached to you so the emergency stop is activated at the time of accident.

After using silicone oil, keep it away from children's reach to avoid accidental ingestion.

Do not wear clothes that can easily hook onto the treadmill.

Keep the power cord away from hot objects and surfaces.

Do not use the treadmill in the open air.

Do not perform repairs yourself or allow non-authorised persons to disassemble or perform repairs on the treadmill. If repairs are required, cease use immediately and contact intertrack.net for assistance.

Do not use the treadmill if it is damaged in any way.

Do not use when intoxicated.

The treadmill can not support more than maximum weight of 220kg.

Power off and unplug the treadmill before moving.

Clean the treadmill regularly. See the Cleaning & Care section of this user guide.

Switch off the treadmill after use.

Electrical Grounding

- Use this product with appropriate electrical grounding. If there is malfunction, the grounding system will provide a low resistance pathway to ground to protect against electric path.
- Install this product using Equipment-Grounding Conductor (EGC) and grounding plug. The plug must be inserted into the proper plug base that has been correctly installed and grounded according to the local laws or regulations. 220V
- If the EGC is connected improperly, it may cause the danger of electric shock. If you doubt whether the grounding of this product is right, authorise professional electrician to check.
- If the grounding plug attached with this product does not match with the plug base, authorise professional electrician to install right plug. 220V
- Ensure that the grounding plug of this product is connected to the plug base that has the same shape. Do not use plug base adapter.

OVERVIEW

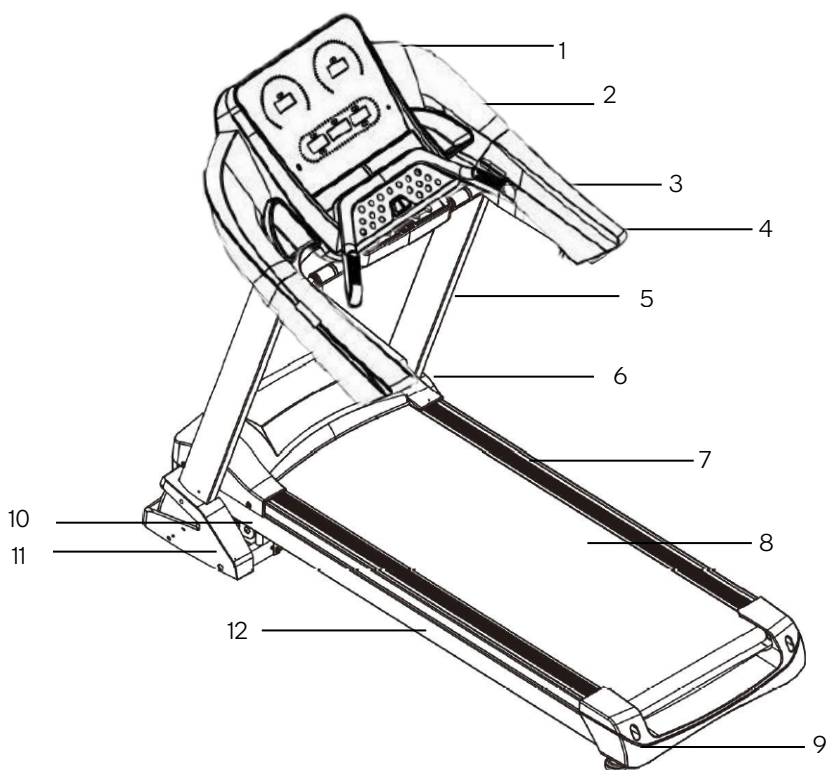

1 Upper Frame

2 Control Console

3 Input Keys

4 Handles

5 Upright Post

6 Calinder

7 Running Deck

8 Running Belt

9 Rear Guard

10 Folding Lock

11 Side Cover

12 Lower Frame

ASSEMBLY

Step 1: installation of complete machine

1. Hold the Column and slowly pull to the fixing hole position.
2. Fix Column onto Pedestal with M8*20,M8*55 screw and M8 flat gasket.
3. Fix Display Meter onto the Column with M8*20 screw and M8 flat gasket.

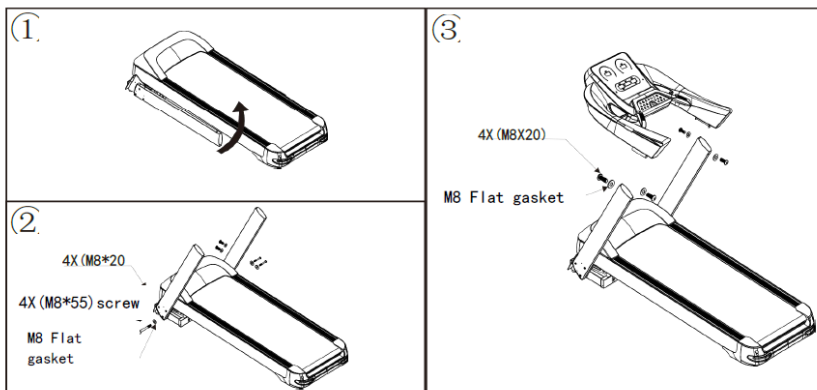

Step 2: Assembly of left and right side covers

1. Remove the package stator that hold the frame and the base, and be careful not to hurt someone when the frame bounces off.
2. Fix the left and right side covers on both sides of pedestal with M4*15 screw and lock them.

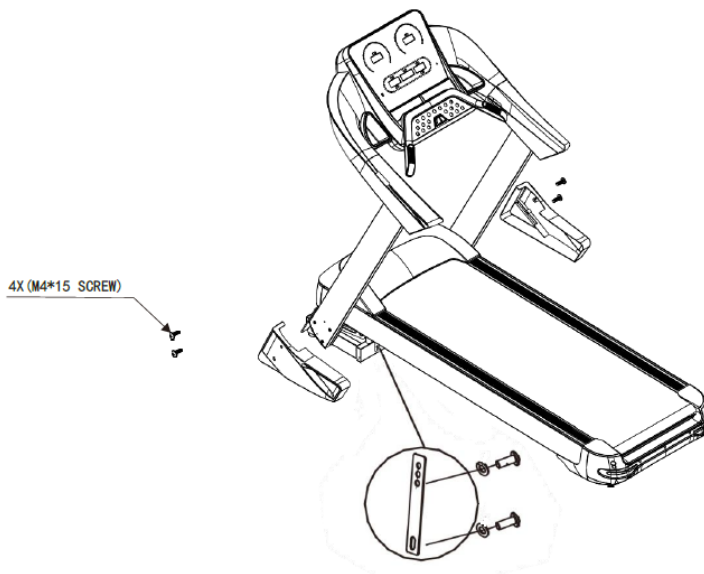

Finally, please ensure that all screws are tightened after all accessories are assembled.

OPERATION





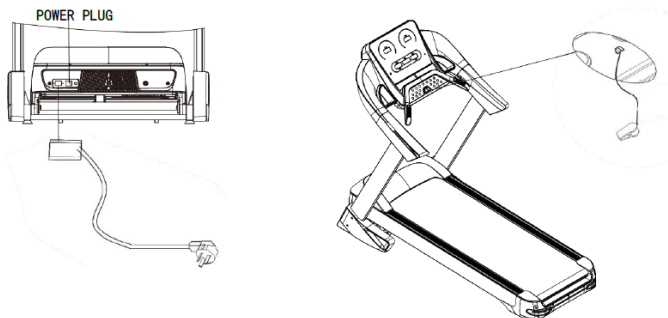



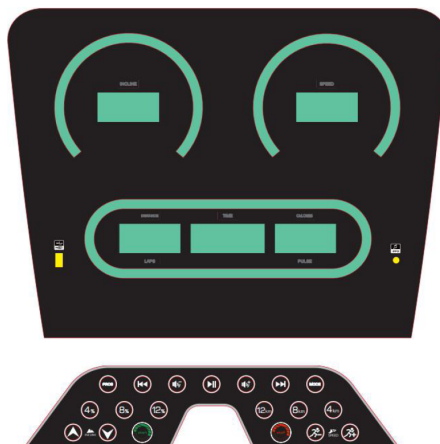

Note: Always use a power outlet that is earthed.

1. Insert power plug into socket and turn on power switch (light turns red). You will hear “beep” and window on instrument panel displays.
2. Place safety lock at yellow position of instrument panel, when the treadmill can be normally used.
3. Please clamp the safety lock onto your clothes when using the machine to avoid accidents.
4. You can open the safety lock at any time to immediately stop the motor to avoid falling over.
5. Please place the safety lock back and start starting program to use the machine again.



Console Operation



	START	To start the treadmill.
	STOP	To stop the treadmill.
	PROG	<p>Following modes available:</p> <ul style="list-style-type: none"> • Manual Control • Automatic Program • Custom Program • HRC Program • Body Fat Test <p>To change functions, do the following:</p> <ul style="list-style-type: none"> • When in Manual Control, press the PROG button to enter the Automatic Program. • Press PROG again to enter Body Fat Test. • Press PROG again to return to Manual Control.
	MODE	To select the Countdown mode.
	SPEED	To adjust the running speed.
	INCLINE	<ul style="list-style-type: none"> • To adjust the incline speed. • When the console is in standby state, press the MODE key to change from speed to incline adjustment.
	VOLUME	To adjust the volume of music playback.
	LAST/NEXT	To cycle between the tracks during music playback.
	Speed Adjustment Key	
	Incline Adjustment Key	

Manual Control Mode

- When the treadmill is in standby, press the START key to start the treadmill and enter manual control mode.
- The initial speed will be 1 kilometer/hour.
- Time, Distance and Calorie counts will start from 0.
- Speed and incline of the treadmill can be adjusted in real-time using the SPEED and INCLINE keys on the console.
- If exercise time exceeds 99: 59 minutes, the time will reset to 0.

Countdown Mode

The treadmill can be set to stop automatically when you reach the desired goal of either Time, Distance or Calories.

- To enter the Time Countdown Mode, do the following:
 1. In the Manual Control mode, press the Mode key to select the Time Countdown mode.
 2. The time display shows 30:00 minutes. The running time can be set via Speed +/- key or Incline +/- key.
 3. Set time range from 8:00 ~ 99:00 minutes. Press the START key to start the timer countdown.
- To enter Distance Countdown mode, do the following
 1. In the Manual Control mode, press the Mode key to select the Distance Countdown mode.
 2. The distance display shows 1.0 km and the distance goal can be set by pressing the Speed +/- key or Incline +/- key.
 3. Set distance range 1.0 ~ 99.0 km. Press the START key to start the distance countdown.
- To enter the Calorie Countdown mode, do the following
 1. In the Manual Control mode, press the Mode key to select the Calorie mode.
 2. The calorie display shows 50 calories and calories can be set by pressing the Speed +/- key or Incline +/- key.
 3. Set calorie range from 20 ~ 990. Press the START key to enter the Calorie mode operation.

During any countdown mode when START is pressed the initial speed will be 1 km/h.

The countdown mode you have chosen will begin the countdown as the other parameters increases.

The speed and incline of the treadmill can be adjusted manually in real-time using the SPEED and INCLINE keys.

As the countdown parameter reaches its goal the treadmill will slow down and enter standby mode.

Automatic Program Function

1. In the Manual Control mode state or MODE setting state, press the PROG key to enter the Automatic Program function.
2. The display shows 30:00 minutes and can be adjusted by pressing the SPEED +/-key or INCLINE +/- key. Set the range to 8:00 ~ 99: 00 minutes.
3. Press the START key to start an automatic program.
4. The automatic program is divided into 20 sections. The Speed and Incline values for each segment run is determined by the automatic program. The run time for each segment is 1/20 of the total set time.
5. Distance and Calories displays starts from 0 and increases.
6. Speed and incline can be adjusted during the automatic program by pressing the SPEED and INCLINE keys.
7. When the automatic program is complete the treadmill will enter the standby mode.

Body Fat Test Function

1. In the Manual Control mode or MODE setting state, press the PROG key to enter the Body Fat Test function.
2. After entering the body fat test settings status, the SPEED display will show the parameters name.
3. The TIME display shows a parameter value to be set. Adjust the parameter value by using SPEED +/- key or INCLINE +/- key.
4. Press the MODE key to select and enter the following parameters:

	Parameters	Initial Value	Range
F-1	Gender	1	Male: 1 and Female: 2 10 to
F-2	Age	25 years	99 years
F-3	Height	170 centimeters	100 to 220 centimeters
F-4	Weight	70 kilograms	20 to 150 kilograms
F-5	Body Fat	---	

5. After entering the parameters, test your Body Fat percentage.
6. Hold the steel sensor plates on the handlebars for about 5 seconds.
7. The body fat percentage will be calculated based on your input parameters and will be displayed on the screen.

Heart Rate Function

- Hold the steel sensor plates on the handlebars. Use natural grip on both handles.
- After about 5 seconds, the LED pulse display window will display a heartbeat initial value. Keep your hands still on the sensors for roughly 30 seconds to get an accurate heart rate measurement.
- The heart rate data will change in real-time if your hands are placed on the sensors.

Note: This heart rate test data is not use for medical purposes and should be .used for sporting purposes only

Sleep Function

- When the treadmill stops running and there is no operation for more than 10 minutes, the sleep mode will be activated. The display is turned off automatically.
- Press any key to wake it up.

Safety Tether and Safety Lock

- Before operating the treadmill, ensure the safety tether is placed in the specified location.
- If the safety tether is missing or not correctly connected the control console will display E07 or "—" with a warning note.
- If the safety tether is removed when operating the treadmill, the system will quickly shut down and the safety lock is activated. The data in the display will be cleared.

Display Parameters Range

	Initial	Program Initial Value	Setting Range	Display Range
Time (Min: Sec)	0:00	30:00	8:00 - 99:00	0:00 ~ 99:59
Speed (Km/h)	0.0	1	1-18	1 - 18
Distance (Km)	0.00	1.00	1.0 - 99.0	0.0 - 99.9
Pulse (Times/Min)	P	N/A	N/A	40 - 199
Calories (Kcal)	0.0	50.0	20 - 990	0 - 999
Incline (Level)	0	0	0 - 15	0 - 15

Folding the Treadmill

1. Before moving the treadmill, ensure it is turned off and unplugged from the power outlet.
2. Release the Folding Lock. Fold the Running Deck towards the Upper Frame by holding the Rear Guard as shown in the image.

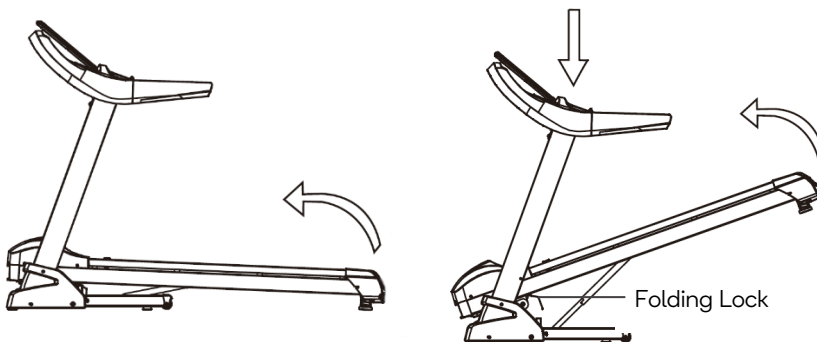

3. The Cylinder will lock the Running Deck in the upright position.

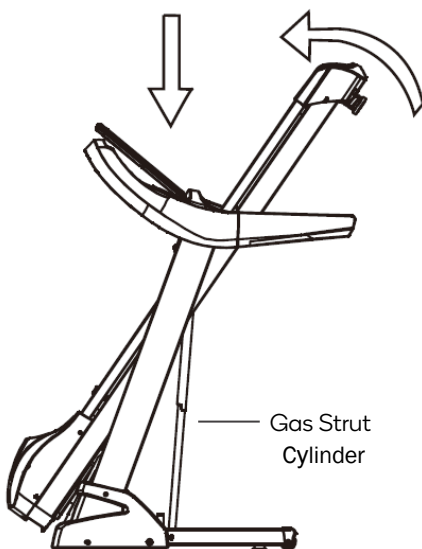

Moving the Treadmill

1. Fold the treadmill as per the instructions under the Folding Treadmill section.
2. Move the treadmill by placing a foot at the base to hold it steady. Pull the treadmill towards you by the hands.

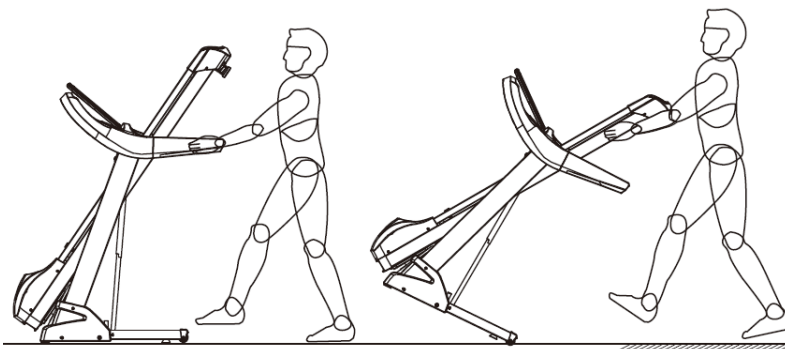

3. After moving to a safe place for storing, gently tread the Cylinder as shown in the image below. The Running Deck will slowly fall to its position.

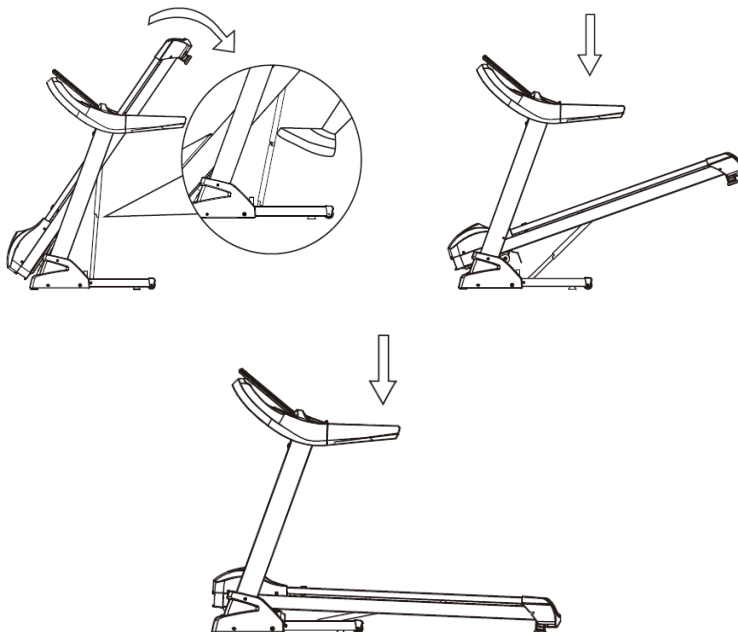

CLEANING & CARE

Appropriate maintenance is required to keep your treadmill in optimal condition. Incorrect maintenance will damage or shorten the service life of the treadmill.

Regulate the Running Belt

- The running belt can be adjusted in two variables: the degree of tightness and central position of the running belt.
- The running belt has been adjusted when leaving the factory, but it will be stretched after use. Deviation from a central position can cause damage by wearing the trim strip and rear protecting cover. It is normal for the belt to stretch throughout its use.

Adjust the Running Belt

If the running belt is slipping during use or tends to get caught and not run smoothly, adjust the tightness of the belt. Follow the below instructions:

1. Insert the regulating screw on the back left of running belt using 5 millimeters hexagon wrench. Turn the wrench by 1/4 of a circle clockwise to regulate the rear roller to tighten the running belt.
2. Repeat step 1 to adjust the screw on the right. Ensure that the regulating screw is turned by the same distance to make the rear roller parallel with the frame.
3. Repeat step 1 and 2 until the running belt is tight.

Note: The running belt should not be too tight as it can damage the running belt, roller bearing and increase the pressure of front/rear roller causing abnormal sound or other problems.

4. If the running belt is too tight, to reduce the tension of the running belt, turn the wrench anticlockwise by same distance on both sides.

Adjust Running Belt Position

When using the treadmill, the force of your feet can cause pressure on running belt and making it unbalanced, which makes the running belt deviate from the center portion.

Such deviation is normal. It will return to the center position when nobody is running on the running belt. Adjustment is needed if the belt fails to return to the central position.

Follow the instructions below to adjust the position of the belt:

1. Activate the treadmill without a runner on it and adjust speed to 6 kilometers/hour.
2. Observe the distance of the running belt from left edge strip to right edge strip.
3. Do the following:
 - If the running belt tilts towards the left, turn the left screw by 1/4 of a circle clockwise with a hexagon wrench.
 - If the running belt tilts towards the right, turn the right screw by 1/4 of a circle clockwise with a hexagon wrench.
 - If the running belt is still not in the middle, repeat the above steps until it is in the middle.
 - After adjusting the belt, set the speed to 16 kilometers/hour. Observe deviation of running belt and running smoothness. Repeat the adjustment steps in case of deviation.
4. Ensure that after the adjustment the running belt is not too tight nor loose.

Note: The running belt should not be too tight as it can damage the running belt, roller bearing and increase the pressure of front/rear roller causing abnormal sound or other problems.

5. If the running belt is too tight, to reduce the tension of the running belt, turn the wrench anticlockwise by same distance on both sides as shown in the image.



Adjust running belt to back of treadmill on both sides.

Automatic Lubricating Oil

The treadmill is oiled when leaving the factory, lubrication process of the treadmill is automatically oiled frequently during use upon need. so please stay alert to check the silicone oil bottle and be sure it is not empty in order to let the treadmill lubricated successfully upon need.

Note: Do not operate the treadmill while lubricating. Use only non-petroleum silicone oil.

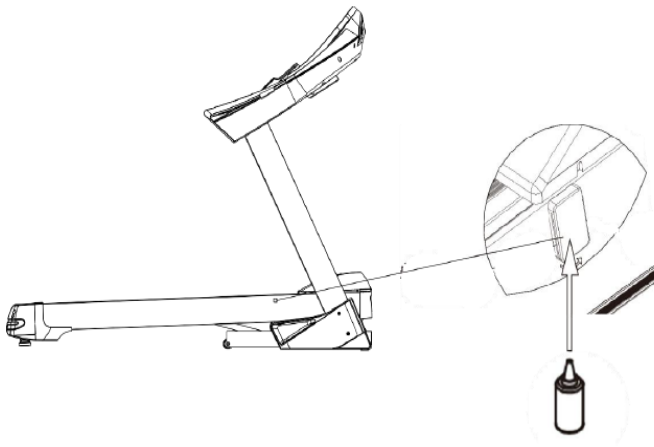

Cleaning

Frequently clean the treadmill to guarantee its service life.

- Cut off the power when cleaning the treadmill. The power line must be pulled out from the outlet.
- Clean sweat stains on the instrument and other parts with a clean towel and damp cloth.
- Do not use corrosive articles and liquid to prevent damage to electronic elements. Do not expose electronic elements to sunlight.
- Place the treadmill in a clean and dry environment. Ensure that power switch is off and is not plugged to a power outlet.

TROUBLESHOOTING

For any of the following described problem, please contact intertrack.net

Code	Description	Solution
E01	Poor Communication between Speed Sensors and Control Console	
		Inspect connections between speed sensors and control console.
E02	Short Circuit	If there is open circuit in the treadmill motor, cease use immediately
		If there is a poor contact with the motor, check the connection.
E03	Speed Sensor Failure	If the speed sensor is not in correct position, adjust its position.
E04	Overvoltage	Ensure the power supply match the treadmill's rated power.
E05	Overcurrent Protection	Ensure the resistance of the running deck is not too high. If it is, lubricate the treadmill. See the Cleaning & Care section of this user guide.
E06	Diagnostic Testing Error	Check the control console
E07 or ---	Safety Tether is in Incorrect Position	Ensure to connect the safety tether to the control console.
	Safety Lock System Error	

SPECIFICATIONS

Motor AC 5.0HP

Automatic incline: 0 - 18%

Max user weight: 220 kg

Speed: 1 - 20 km/h

Running area: 150x52 cm

N/G Weight: 102/114 kg

LED touch screen (Heart rate, calories, distance)

Oil system: Automatic lubrication with oil guide tube

Duration of consistent usage : 5 hour (30 Minutes rest in between)



Need more information?

We hope that this user guide has given you the assistance needed for a simple set-up. For the most up-to-date guide for your product, as well as any additional assistance you may require, head online to

support@intercheim.com
support@intertrack.net



intertrack.net